

# PRAIRIE DOG TOWN 4 MILE

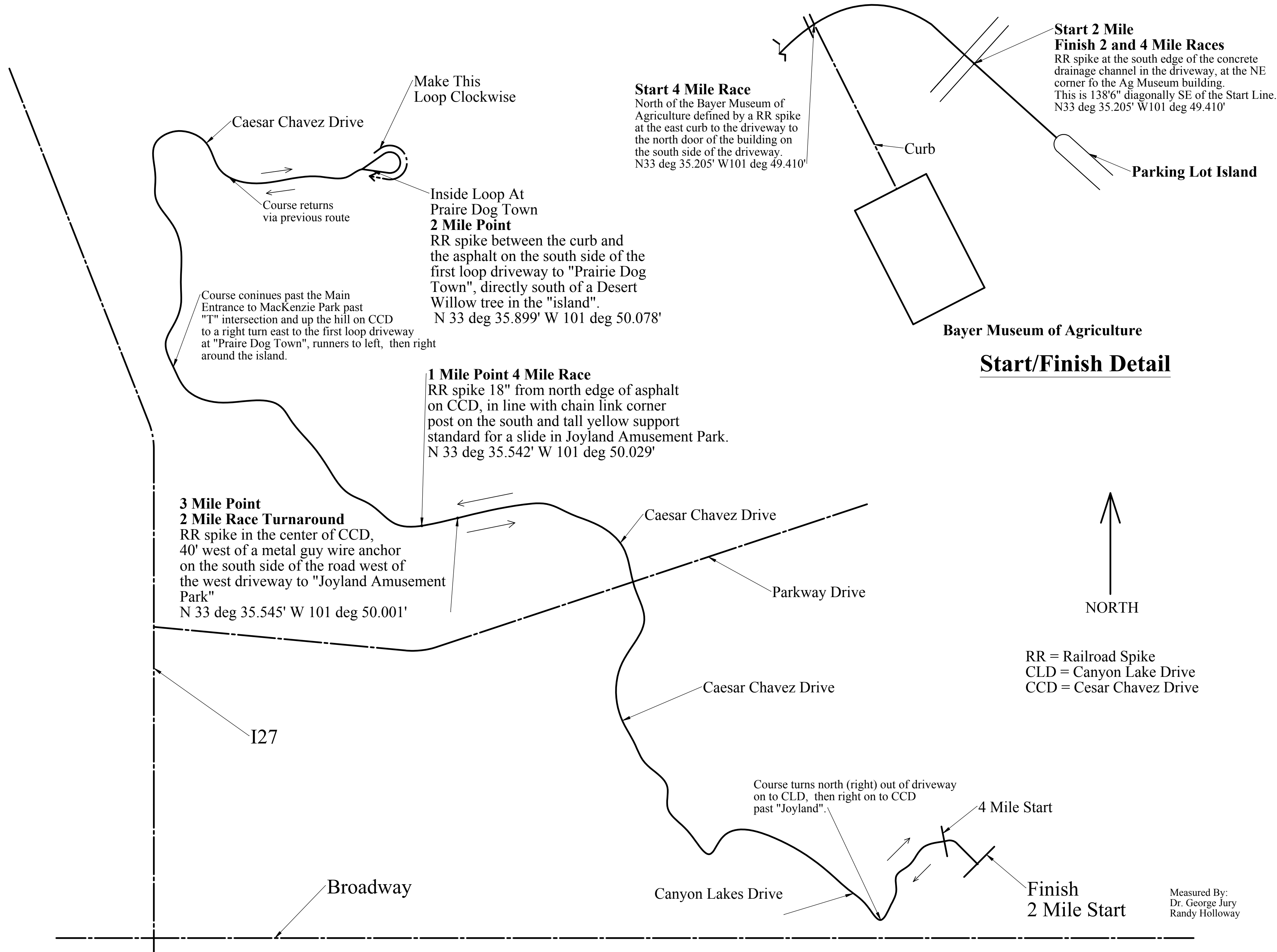

Make This Loop Clockwise

Caesar Chavez Drive

Course returns via previous route

Course continues past the Main Entrance to MacKenzie Park past "T" intersection and up the hill on CCD to a right turn east to the first loop driveway at "Prairie Dog Town", runners to left, then right around the island.

**Inside Loop At Prairie Dog Town 2 Mile Point**  
RR spike between the curb and the asphalt on the south side of the first loop driveway to "Prairie Dog Town", directly south of a Desert Willow tree in the "island".  
N 33 deg 35.899' W 101 deg 50.078'

**1 Mile Point 4 Mile Race**  
RR spike 18" from north edge of asphalt on CCD, in line with chain link corner post on the south and tall yellow support standard for a slide in Joyland Amusement Park.  
N 33 deg 35.542' W 101 deg 50.029'

**3 Mile Point 2 Mile Race Turnaround**  
RR spike in the center of CCD, 40' west of a metal guy wire anchor on the south side of the road west of the west driveway to "Joyland Amusement Park"  
N 33 deg 35.545' W 101 deg 50.001'

**Start 4 Mile Race**  
North of the Bayer Museum of Agriculture defined by a RR spike at the east curb to the driveway to the north door of the building on the south side of the driveway.  
N33 deg 35.205' W101 deg 49.410'

**Start 2 Mile Finish 2 and 4 Mile Races**  
RR spike at the south edge of the concrete drainage channel in the driveway, at the NE corner fo the Ag Museum building. This is 138'6" diagonally SE of the Start Line.  
N33 deg 35.205' W101 deg 49.410'

## Start/Finish Detail

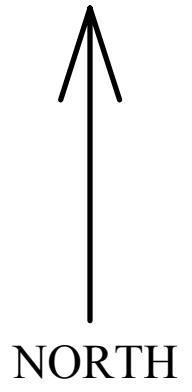

RR = Railroad Spike  
CLD = Canyon Lake Drive  
CCD = Cesar Chavez Drive

Measured By:  
Dr. George Jury  
Randy Holloway